

You're space hasn't changed since? Maybe it should now.

As homes shrink and social life becomes more fluid, spaces need furniture that moves with people, not against them. Divia was designed for exactly this moment.

THE PROBLEM

Furniture is static. One function. Same spot. Same shape.

sofa, fixed, 1 function

table, fixed position, cannot move

One shape, one use, one configuration.
No room to adapt. No room to grow.
Excludes others, no room to adapt
The space serves the furniture, not you.

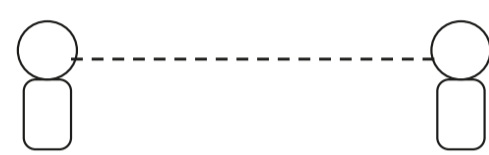

2 people, fixed, no flexibility

DIVIA

One system. Infinite configurations. Space that grows.

The pieces

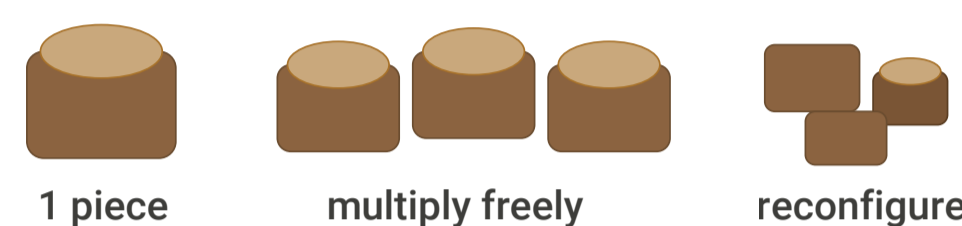
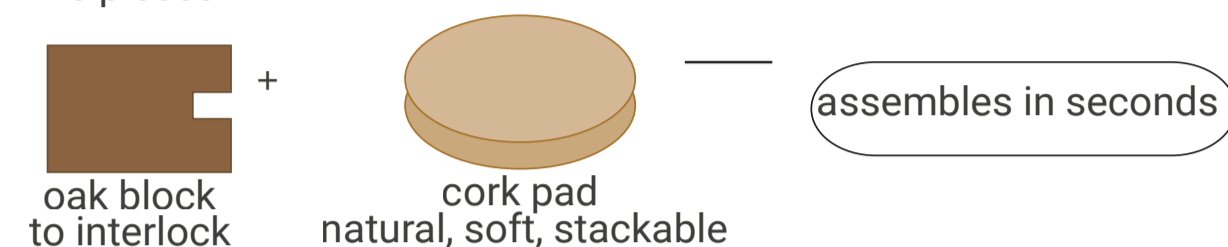

Multi function

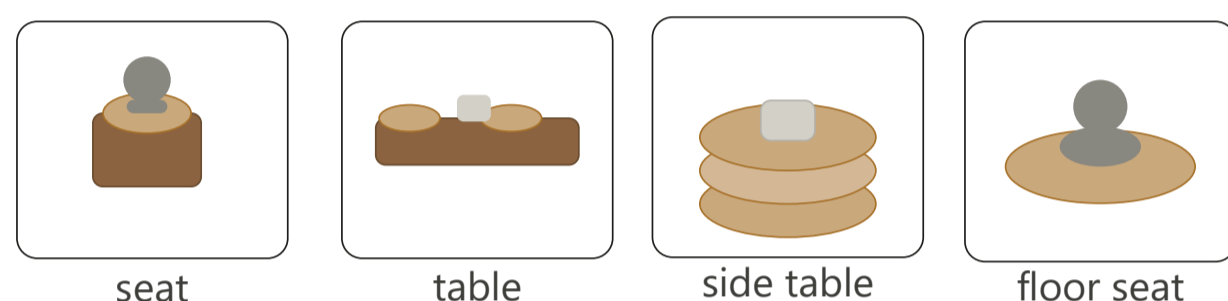

Same pieces. Entirely new space. New ways to gather, move, and interact.

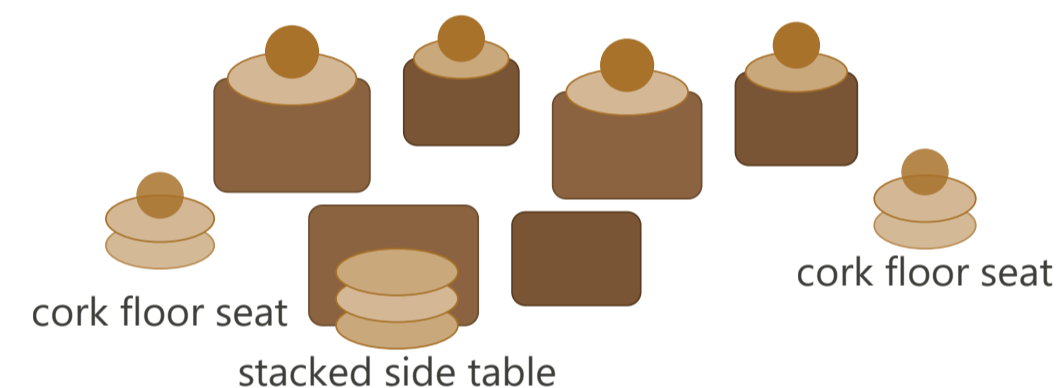

CONCEPT / INSPIRATION

Natural Pattern Study

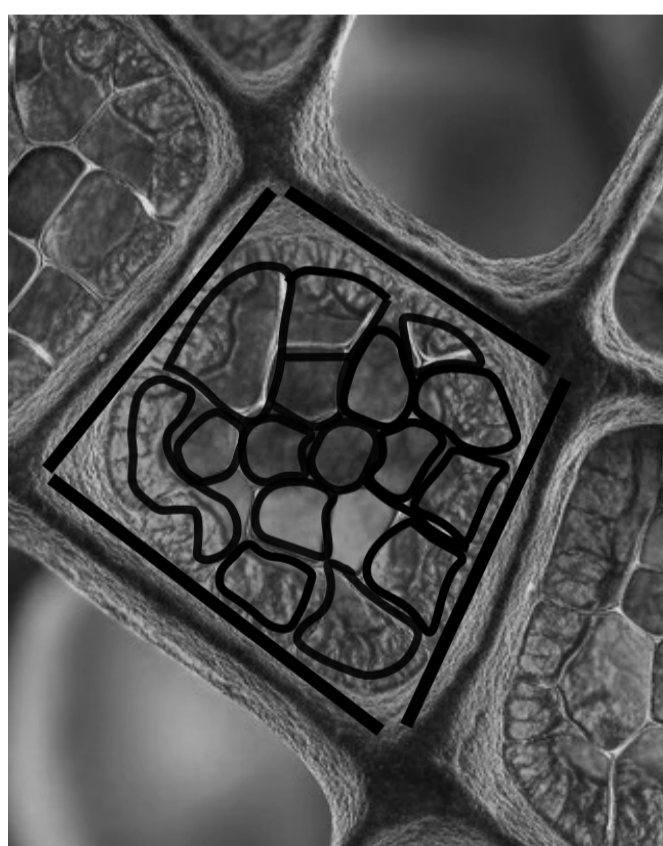

Inspired by living systems in nature, the project translates the organic expansion of cellular structures into a modular furniture system.

The furniture does not only reproduce a natural pattern; it also acts like one.

Each element can separate, connect, and adapt to new uses.

This logic leads to scalability and assembly, bringing not only natural shapes indoors, but an entire natural system.

Cellular growth system
Small units join together to create a larger system.

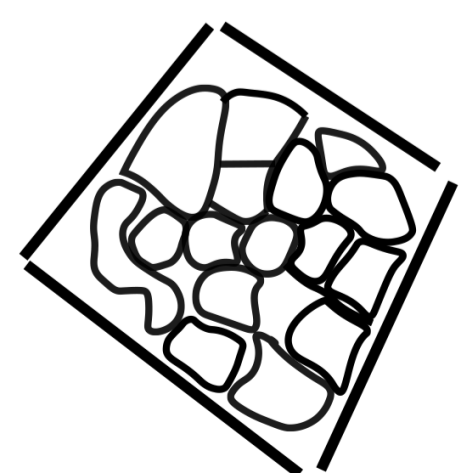

PATTERN 1 Cellular cluster

Cells gather, separate, and rearrange into flexible organic units.

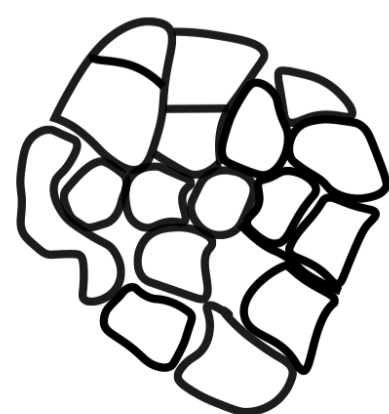

PATTERN 2 Modular block

A simple block is divided into sculptural units that can expand and recombine..

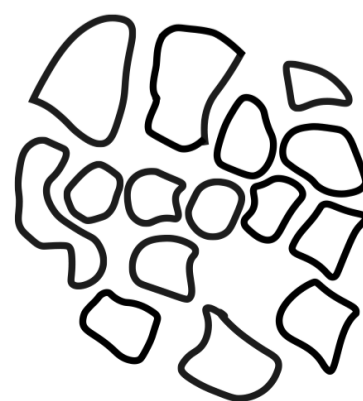

THINKING PROCESS

01 Unit extraction The unit follows a cellular cluster logic: expand, combine, reconfigure.

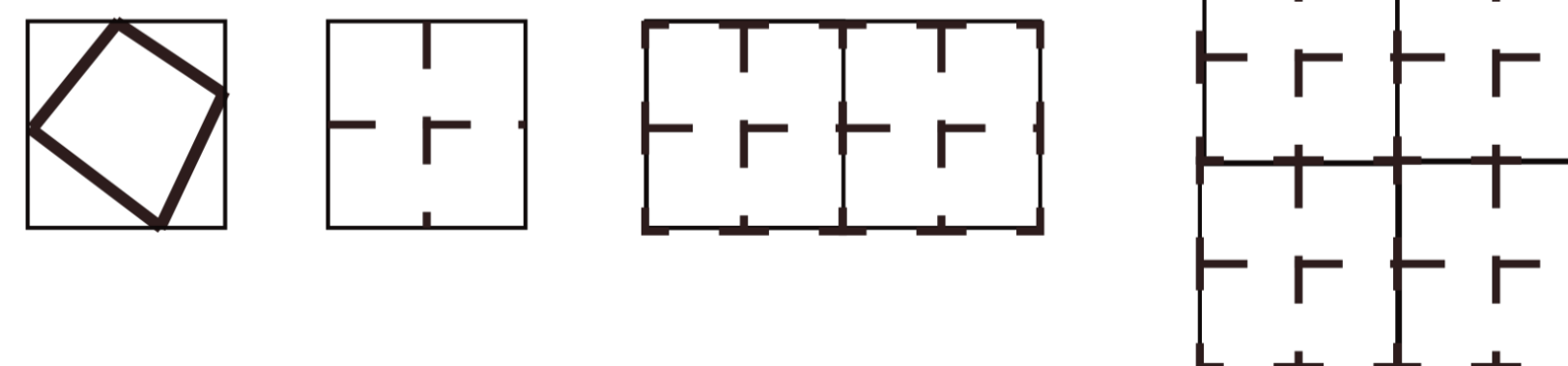

02 Imbrication

The units interlock to create a scalable wooden base.

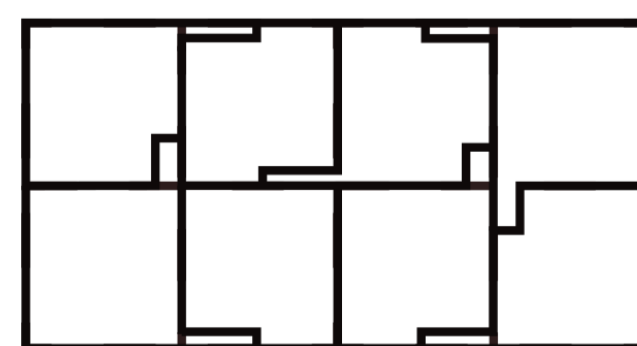

03 System combination

The rigid grid and organic cork cells are combined.

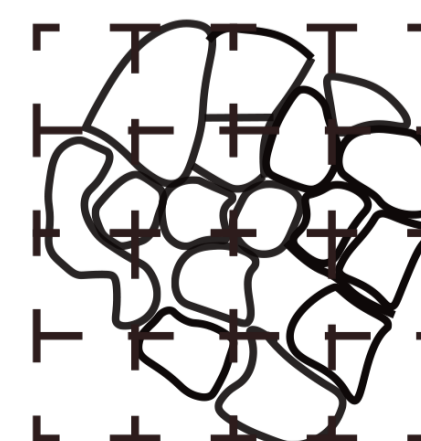

04 Final piece

The furniture does not only biomimic cells; it behaves like a living system.

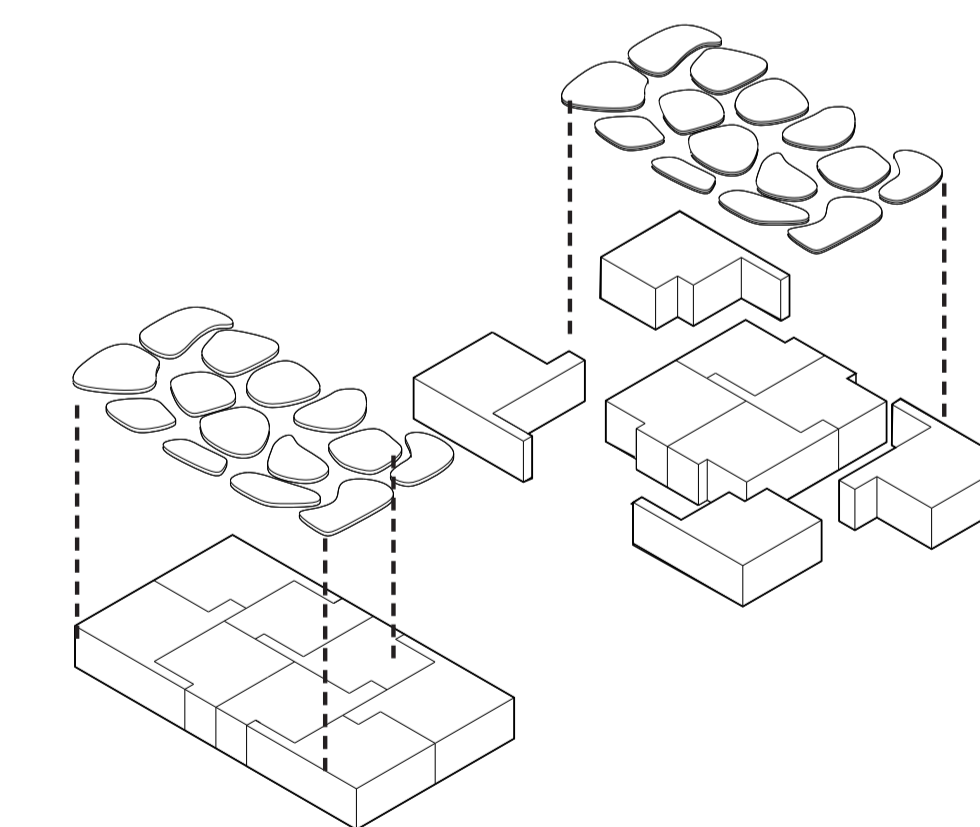
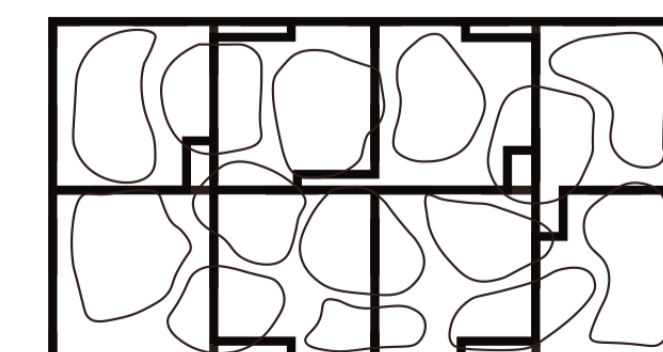

TOP VIEW

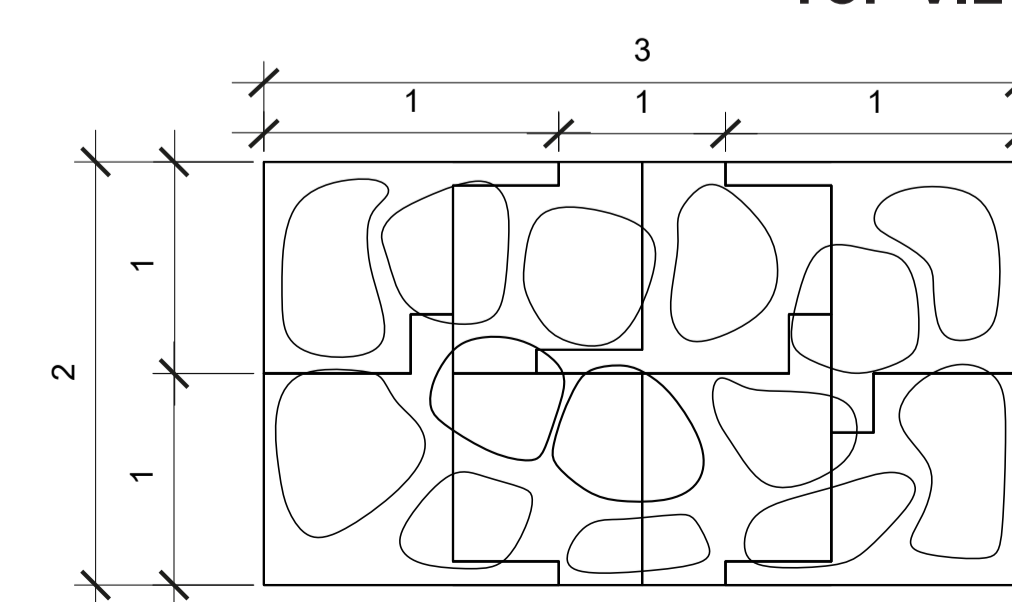





MODULAR CONFIGURATIONS

From one grain to many, the system grows through repetition, connection, and expansion. Just like a living natural system.

01 From one to many

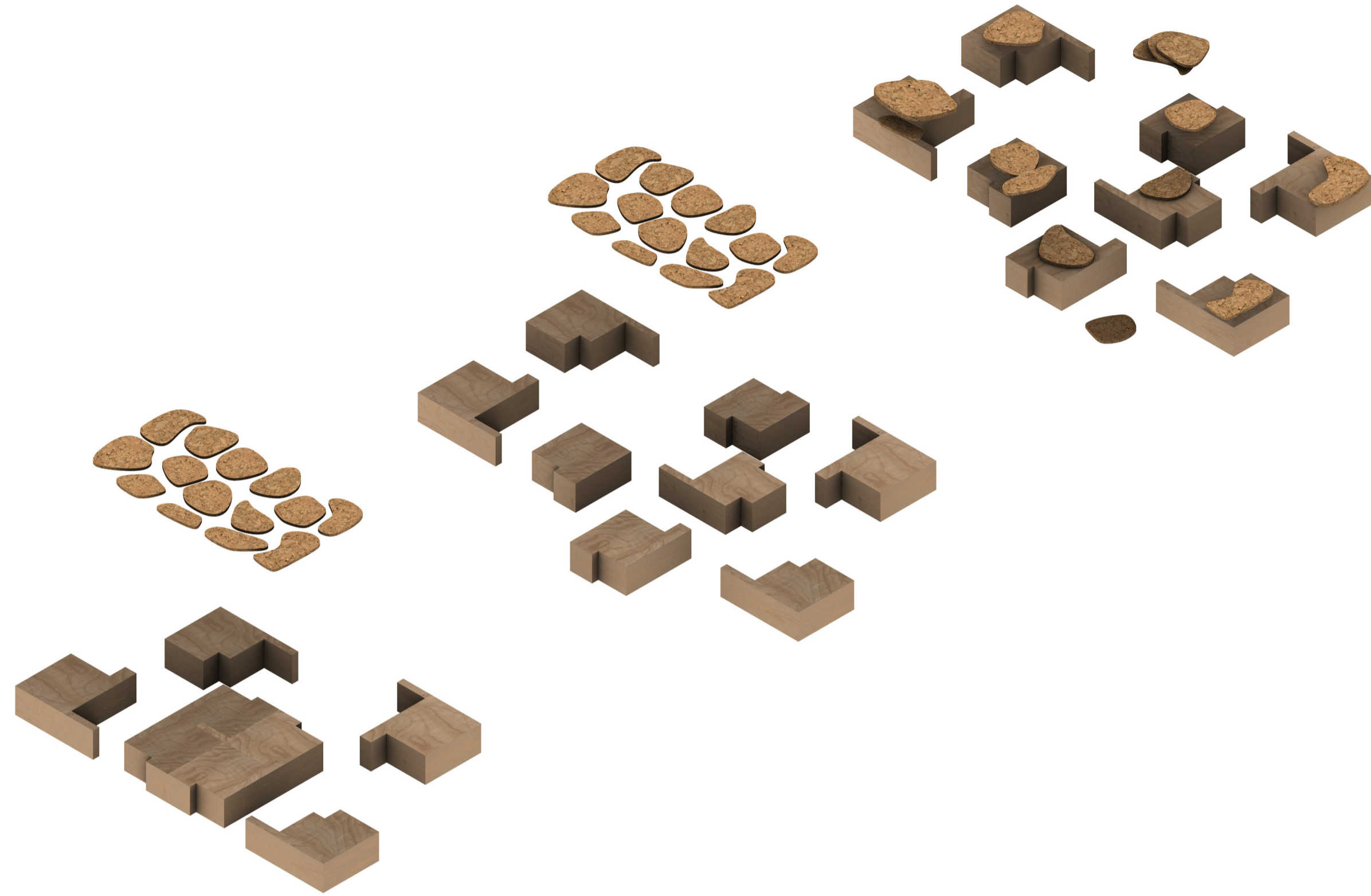

One table expands into multiple interlocking side tables.

02 Grouped configurations

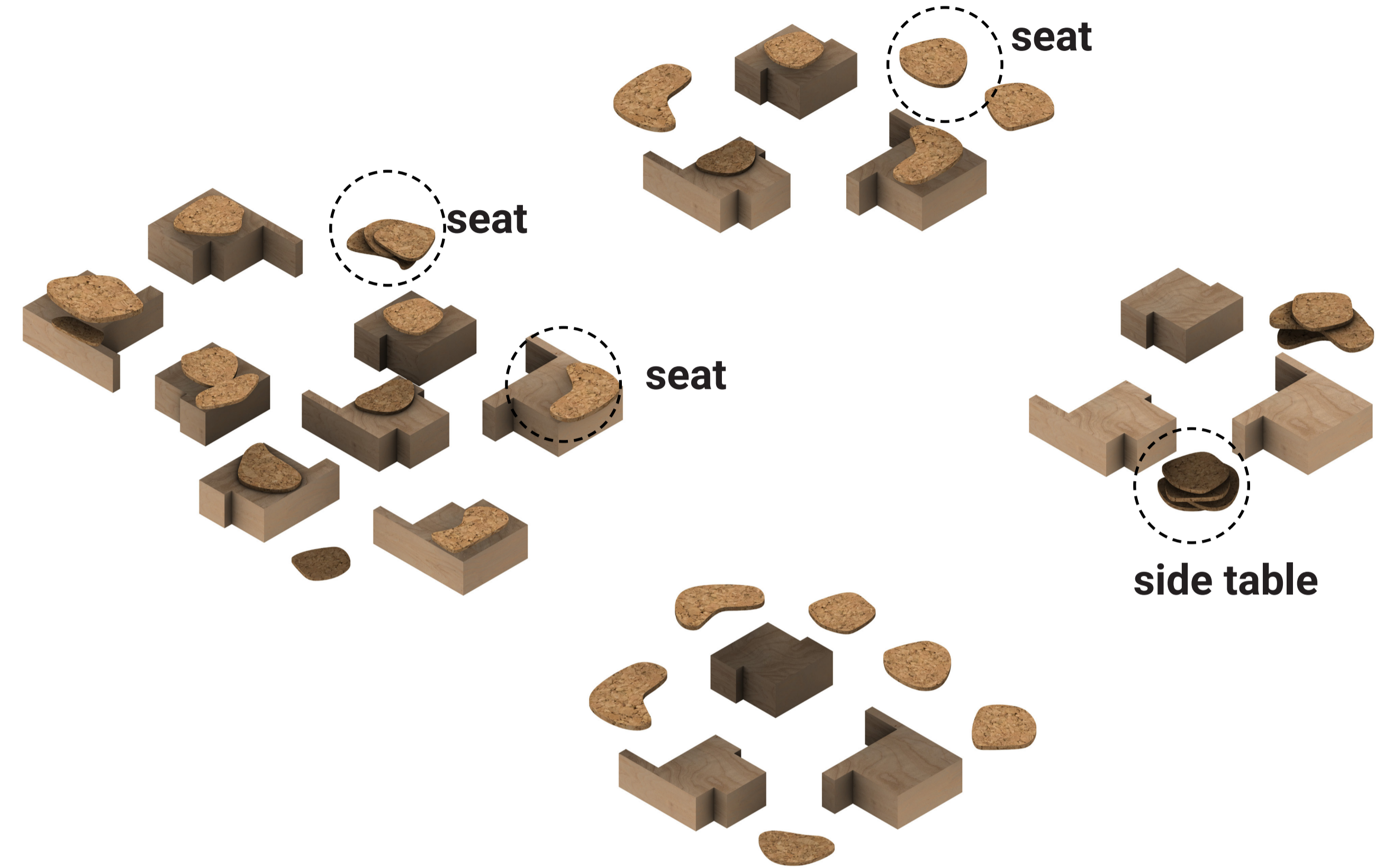

Wood and cork elements form different seating and table arrangements.

03 Flexible / Expansion use

Joined, the modules create a table; separated, they become seats or side tables.

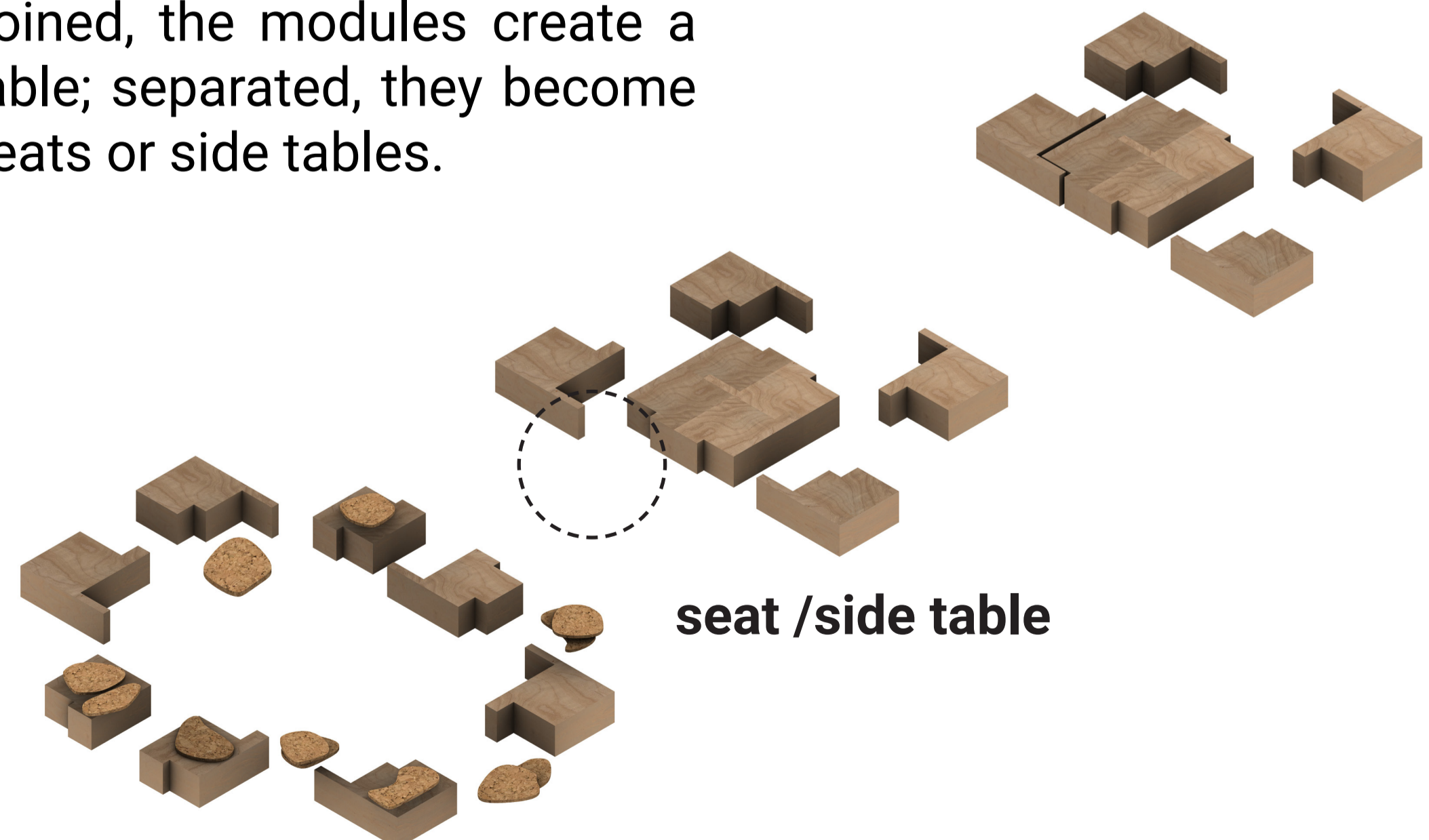

04 Wooden modules

The wooden units can be used individually as seats or side tables.

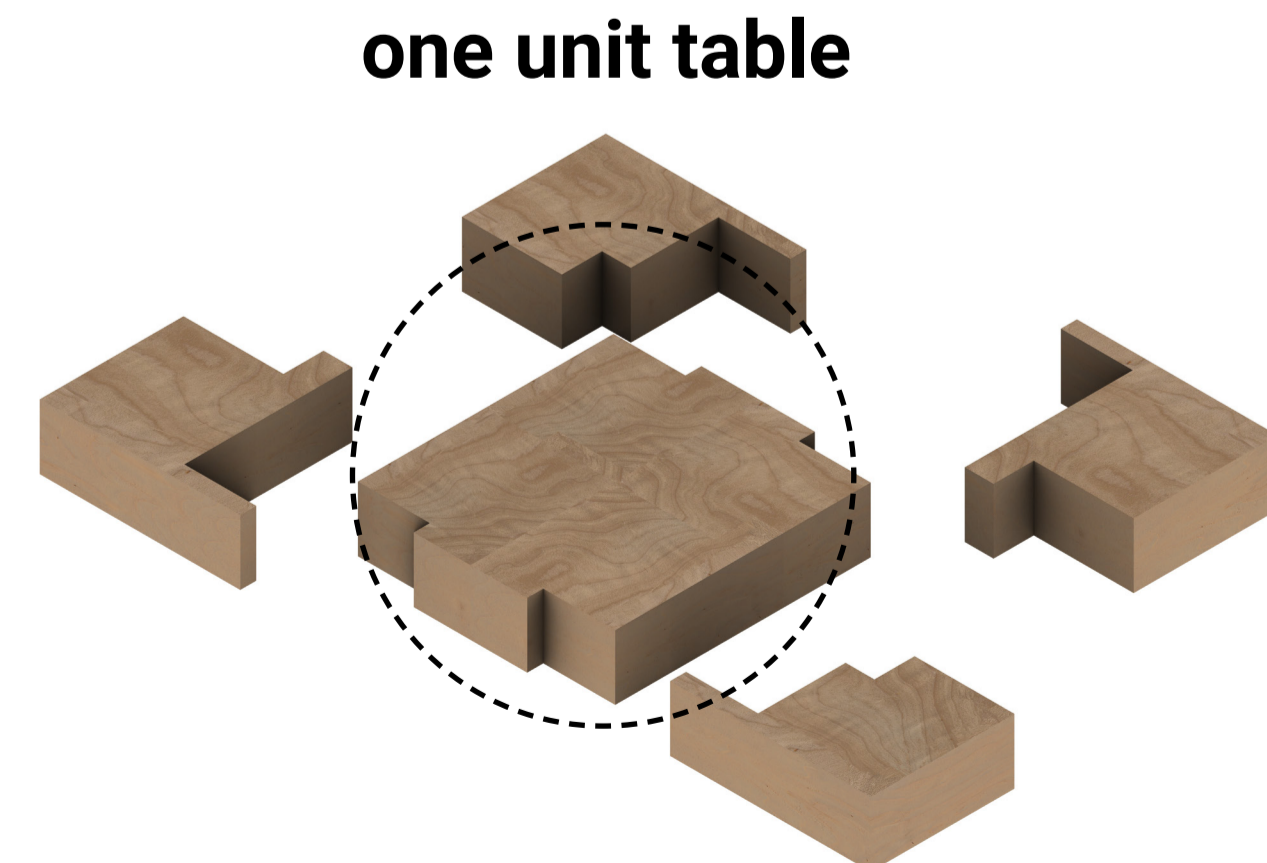

05 Cork modules

The cork elements can function as floor seats, stacked side tables, or soft complements.



Only four pieces, many possible configurations.

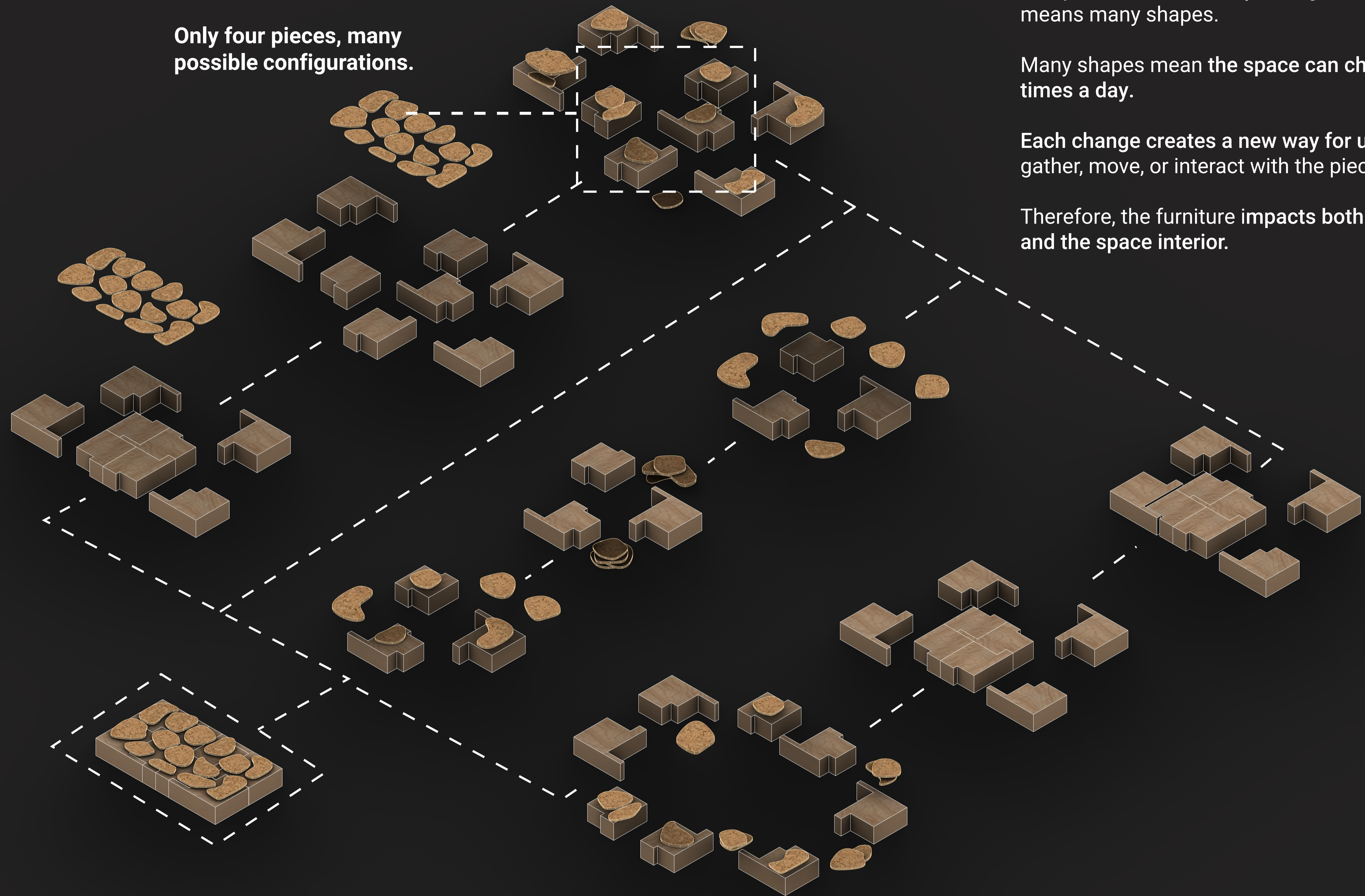

One piece can take many configurations, which means many shapes.

Many shapes mean the space can change several times a day.

Each change creates a new way for users to sit, gather, move, or interact with the piece.

Therefore, the furniture impacts both the users and the space interior.

MATERIALITY

oak wood - corks



Solid oak lasts generations. Cork is self-renewing. Every piece is repairable individually, nothing needs to be replaced whole.



At end of life, cork and oak return to the earth completely, no synthetic residue, no landfill, no trace. The cycle closes as cleanly as it opened.»





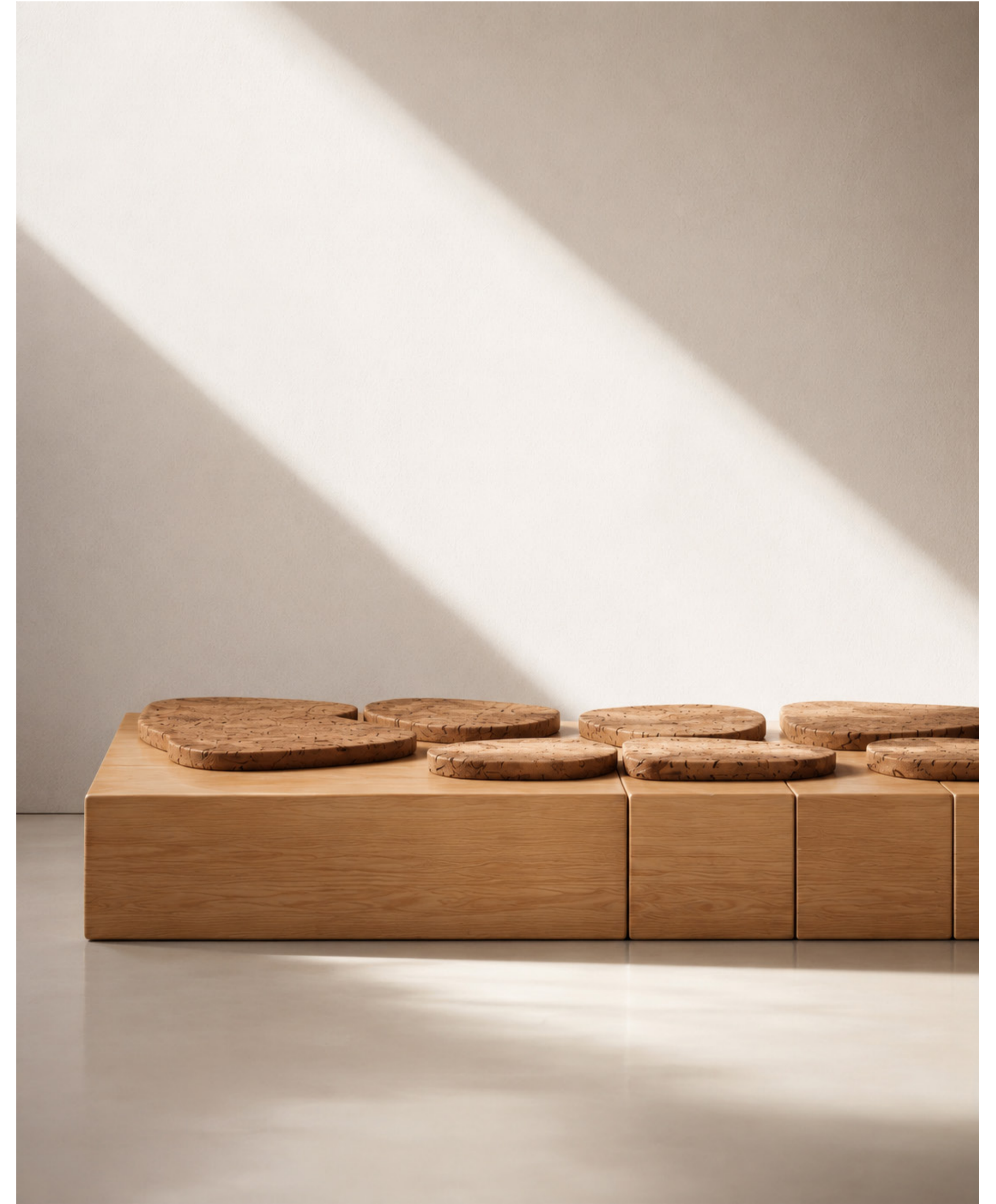

divia







divia





divia

«not just a piece, its a natural identity»

PROS

- Pure natural materials ,cork and solid oak, nothing else
- Zero synthetic components, zero landfill
- No joints, no mechanical fixings, no hardware , the form is the connection
- Eco-friendly from harvest to end of life , tree stays alive
- Brings nature inside the home, not as decoration but as material logic
- A living system , it grows, multiplies, reconfigures like the organism that inspired it
- Multi-use , seat, table, side table, floor cushion, all from the same piece
- Scalable , one module or one hundred, same logic applies
- Lifts and transforms social gatherings , the space adapts to the people, not the other way around
- Modern aesthetic with a timeless natural foundation

CONS

- Solid oak blocks are heavy , reconfiguring a large setup isn't effortless, especially for one person
- Not suitable for outdoor or humid environments , oak and cork are sensitive to moisture and temperature swings



divia business model

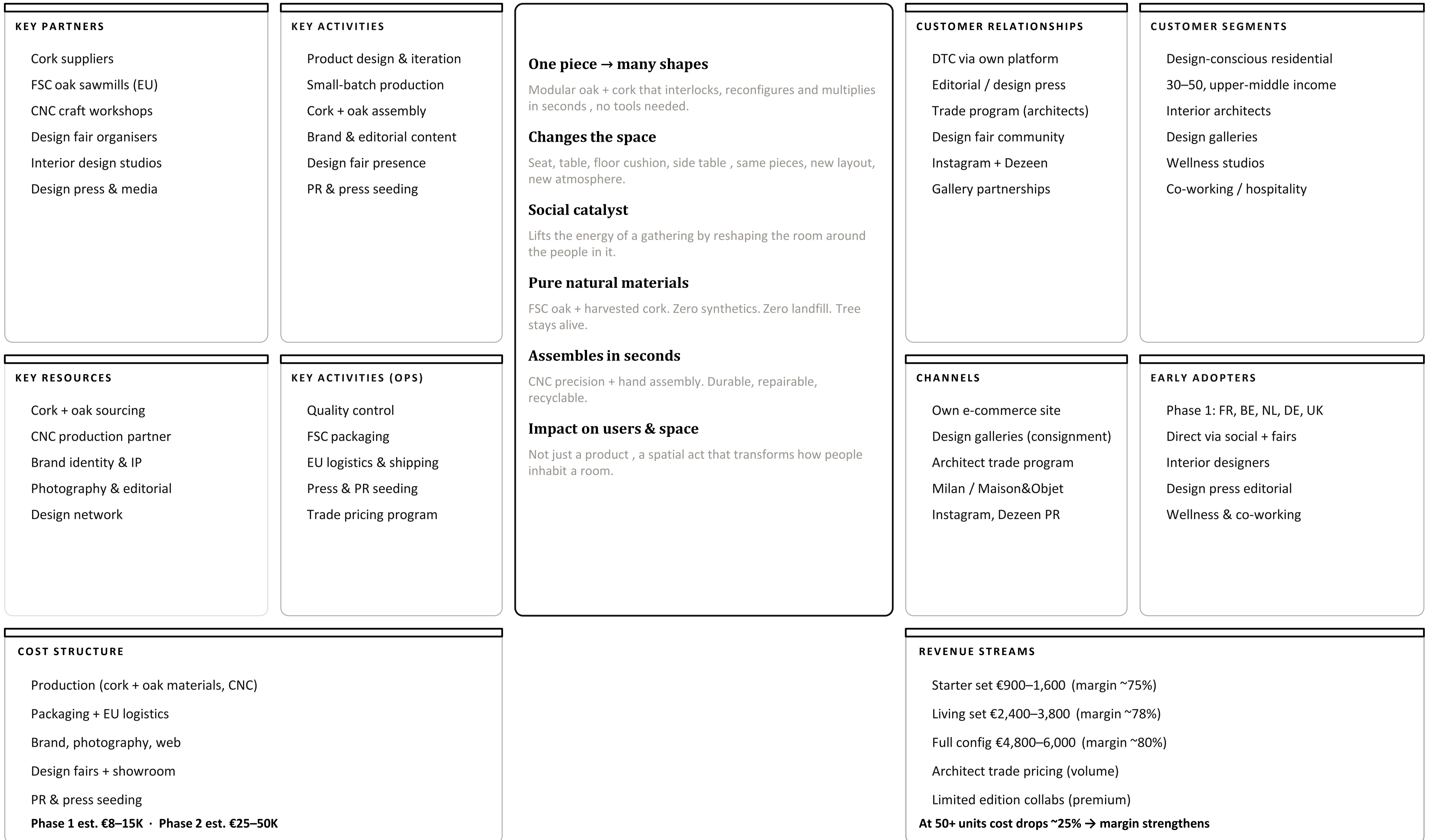

<p>SUSTAINABILITY Materials</p> <p>Cork harvested without felling the tree · Zero synthetic input</p>	<p>Production</p> <p>Small-batch, EU-local · Low waste CNC + hand assembly</p>	<p>Longevity</p> <p>Designed to last decades · Individual pieces repairable</p>	<p>End of life</p> <p>Cork + oak fully biodegradable · No landfill · Closed loop</p>
---	---	--	---

divia

Can be commercialized as an individual piece or as a complete interlocked system.

Please check the two videos inserted , it has full mockup website (mobile - desktop versions)

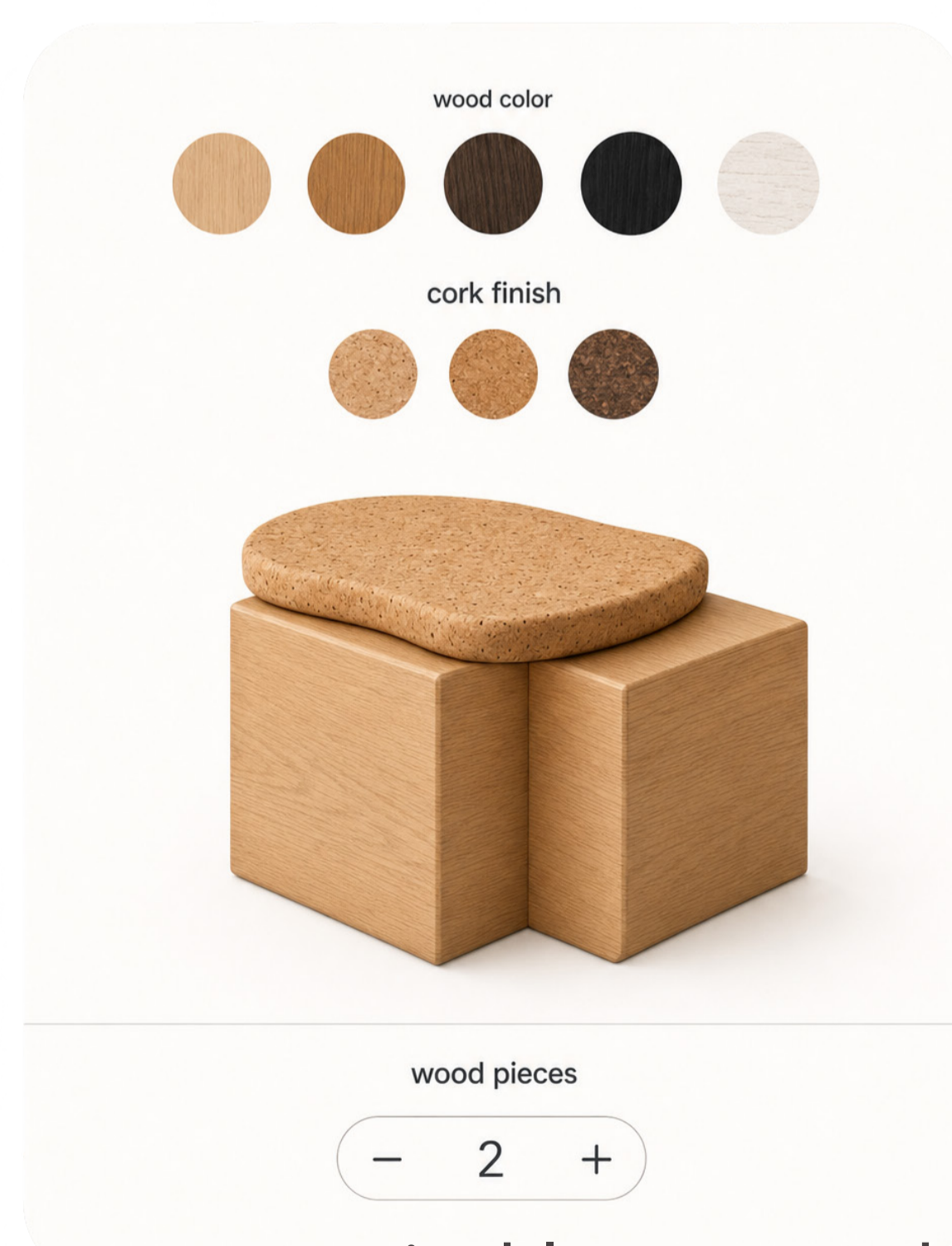

customizable wood dimension units - cork thickness





divia

DIVIA
MODULAR FURNITURE SYSTEM

Solid oak and cork.
One piece, many scenarios.
Inspired by cellular growth.





form

ISSUE 28
SUMMER 2024

OBJECTS FOR A CONSCIOUS LIFE

Sculptural
Living
p.24

Material
Honesty
p.36

Design That
Lasts
p.46

DIVIA

Natural Modularity

A modular furniture
system that adapts,
evolves, and endures.



mock-up magazine

The DNA is simple:
Not just nature's look. Nature's logic.

THE METHOD

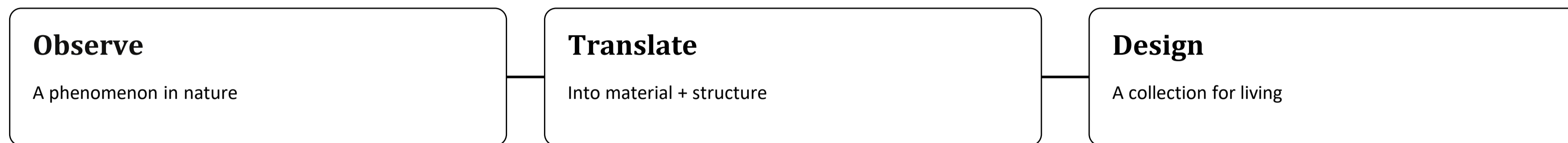

COLLECTION 01 · NOW

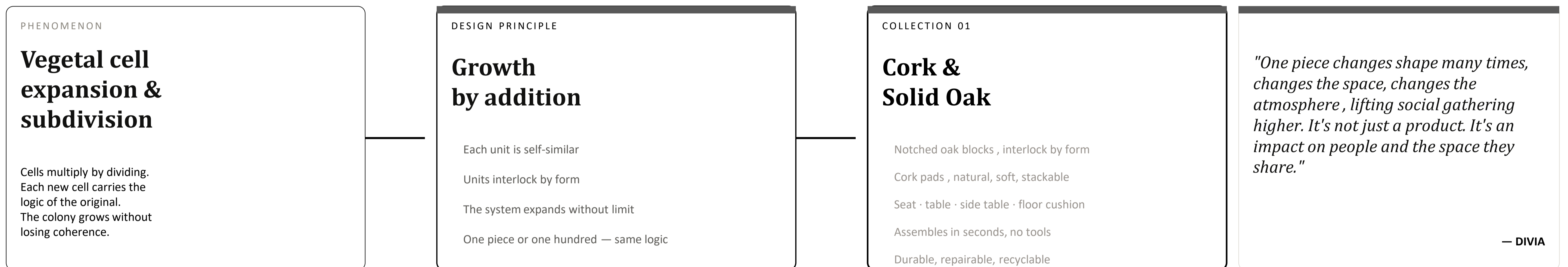

FUTURE COLLECTIONS · THE ROADMAP

Each collection begins with a natural phenomenon. The phenomenon becomes the logic of the object.

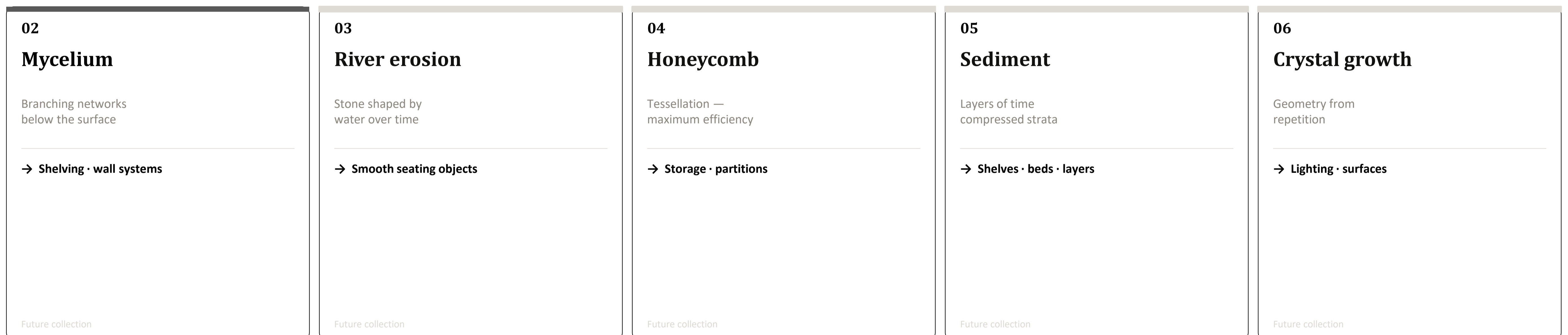

Nature does not design. It solves. DIVIA observes those solutions and gives them a home.